

Safe•t mate®

Model No.
SM2-3LEVEXT

SM2-3 Seat Lever Extension Kit
for use with Invacare SX5 Reclining Wheelchair

Tools Required: 7/16" (or adjustable) wrenches

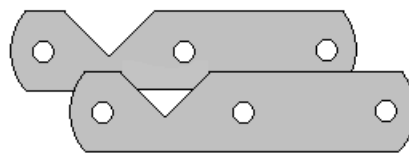

Adapter Plates

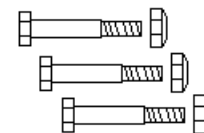

1 3/4" Bolts and Nuts

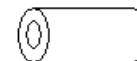

White Plastic Spacer

ASSEMBLY INSTRUCTIONS

1. Disassemble seat lever assembly from its current Configuration. Retain 1.5" bolts and nuts for future use.
2. Locate the 1" long White Plastic Spacer and one of the 1 3/4" long bolts provided. Align adapter plates, insert spacer as shown and install the bolt and nut (hand tight) in location **A**.
3. Align the seat lever rear hole in location **B**. Install 1 3/4" bolt and nut (hand tight).
4. Align the seat lever 2nd hole in location **C**. Install 1 3/4" bolt and nut (hand tight).
5. Using 7/16" wrenches, tighten bolts at locations **A** and **B**.
Tighten bolt at location C only until end of nut is flush with end of bolt. Over tightening will cause distortion of the adapter plates.
6. Refer to SM2-2 Wheelchair Anti-rollback Device Instructions to continue installation.

